

# Thames Quay

Chelsea Harbour, London SW10

**£1,200 per week    Unfurnished**



Harbour  
Estates

5 Design Centre East    Chelsea Harbour    London SW10 0XF  
020 7351 2300    [harbourestates.co.uk](http://harbourestates.co.uk)

*A fabulous 3 bedroom, 3<sup>rd</sup> floor apartment, located in one of the premier buildings within Chelsea Harbour. The apartment is light, bright and offers well-proportioned and well-balanced accommodation with exceptional views of the river from the reception room as well as views of the marina from all three bedrooms. Two underground parking spaces complete the picture.*



Entrance Hall • Cloakroom • Kitchen • Reception Room • 2 Double Bedrooms • 1 Single Bedroom  
2 Bathrooms (1 En Suite) • Dressing Room • 2 Balconies • Lift • Video Entry Telephone  
2 Underground Parking Spaces • 12 hour Weekday Portage • 24 Hour Site Security



Gross Internal Area: 137 Sq. metres  
1477 Sq. feet

Balcony Area: 15 Sq. metres  
162 Sq. feet

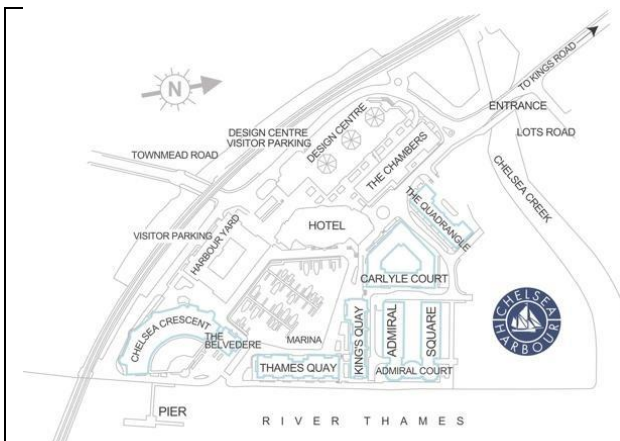
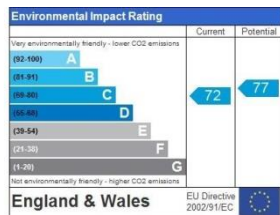
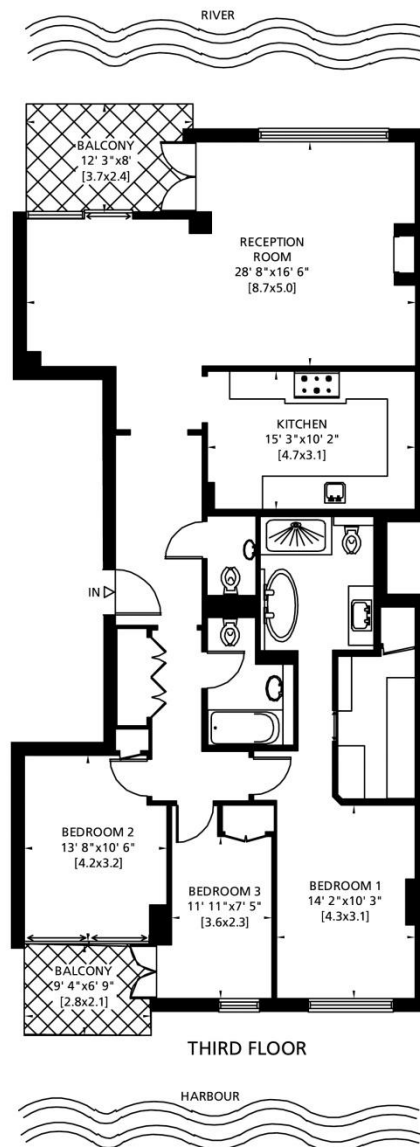

### Chelsea Harbour Amenities:

Riverside Walk • Secure Underground Parking Facilities  
5-Star The Chelsea Harbour Hotel • Blue Harbour Spa  
Chelsea Riverside Brasserie & Bar • Marina • Hairdressing  
Convenience Store • Marcos • Excellent Security

### Local Transport Links:

- 📍 Imperial Wharf Station (Overground)
- 🚶 Under 15 minutes walk to Fulham Broadway (District)
- 🚶 C3 to Chelsea Harbour; 11, 22 & 14 within a short walk
- 🚶 Within easy reach of the Kings Road and Embankment
- 🚕 Taxi Rank at the The Chelsea Harbour Hotel
- 🚤 River Taxi at Chelsea Harbour Pier

**IMPORTANT NOTICE:** Harbour Estates Limited, its clients and any joint agents give notice that they have no authority to make or give any representations or warranties in relation to this property either here or elsewhere, either on their own behalf or on behalf of their client or otherwise. They assume no responsibility for any statement that may be made in these particulars. These particulars do not form part of any offer or contract and must not be relied upon as statements or representations of fact. Any areas, measurements or distances are approximate. The text, photographs and plans are for guidance only. It should not be assumed that the property has all necessary planning, building regulation or other consents and Harbour Estates Limited has not tested any services, equipment or facilities. A buyer or lessee must satisfy themselves by inspection or otherwise. The copyright of all details, photographs and floor plans remain exclusive to Harbour Estates Limited.